

RP1000 — Signature Planter with Powder Coated Steel Panels

20-gallon planter with aluminum corner posts, steel panels, steel contour top and plastic liner

Material

The 20-gallon planter is 25.50" tall and constructed using aluminum corner posts with 14-gauge, perforated steel side panels. The panels have a .5" square perforated design.

The contour top is constructed of galvanized spun steel with a 17" diameter center top opening for easy access and is secured to the planter body with two 8" braided nylon straps. The top lifts off for easy emptying.

The planter is designed to be portable for flexibility in placement or surface mounted to prevent movement. The legs have plastic end caps to protect the floor or supporting surface. The planter includes a reusable plastic liner made of black high-density polyethylene.

Finish

Fade-resistant, powder coated steel top, steel side panels and black aluminum corner posts feature a state-of-the-art primer proven to prevent rusting. Treated components exceed the industry standard by 34% in testing by independent sources. Aluminum corner posts also available in anodized aluminum.

Color

See website or sales representative for color choices.

Assembly

The planter is shipped fully assembled and ready for use.

Maintenance

The product is virtually maintenance-free and requires only periodic cleaning with a sponge and a solution of mild detergent and water to remove surface dirt. Do not clean with solvent or petroleum base products.

Warranty

20-year limited structural warranty with 7-year finish warranty against fading from the date of purchase.

**Replacement Parts**

Black Plastic Liner

R-PCS32PLR

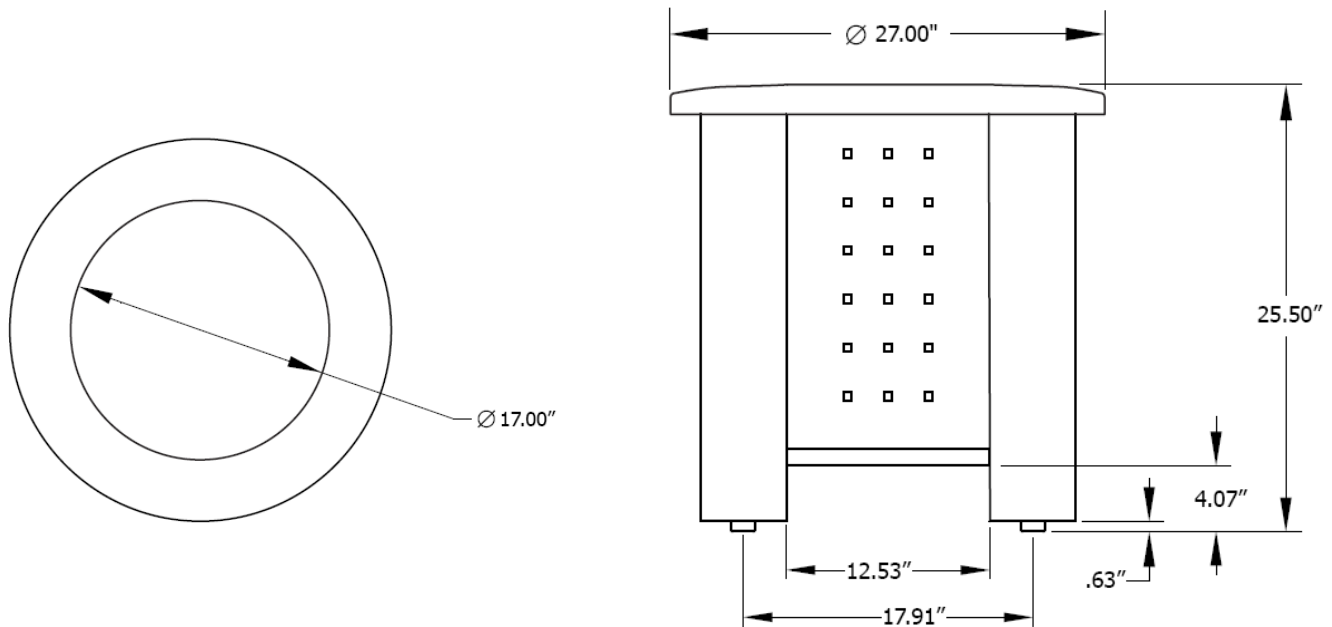
**SHIPPING INFORMATION**

Unit Weight	Unit Shipping Wt. UPS	Unit Shipping Wt. Truck (1+ Unit)	Unit Ship Size w/Pallet	Max Units Per Pallet	Pallet Size/Wt.	Total No. Pkgs.	Shipping Class
56 lbs.	N/A	66 lbs./unit	12 cu. ft.	N/A	N/A	1	125