

**MIX2937B — Mixx Bamboo Bar Height Stool****Bar Height Stool with bamboo planks and steel frame and legs, portable****Material**

The 15.32" square bar height stool is composed of 0.75" x 3.5" (1" x 4" nominal dimensions) bamboo seat planks. The frame and supports are made of 14-gauge steel and are designed to support 200 lbs. per linear foot.

The stool is designed to be portable for flexibility in placement. Each foot features a stainless steel adjustable glide for leveling and to protect your floors. Matching tables are also available.

Mature exterior grade bamboo is selected from sustainably harvested sources and engineered into planks using low V.O.C. adhesives. Planks feature a Janka hardness rating of 1450 that is superior to teak. Bamboo has 20% more stability in climate and temperature changes than commonly used timber. Bamboo has a Class A fire rating—ASTM E 84 Surface Burning.

**Finish**

Fade-resistant, powder coated steel components feature a state-of-the-art primer proven to prevent rusting. Treated components exceed the industry standard by 34% in testing by independent sources.

Bamboo planks feature a UV-resistance stain.

**Color**

See website or sales representative for color choices.

**Assembly**

The stool ships fully assembled. Leveling foot glides may require adjustments.

**Maintenance**

See annual maintenance program.

**Warranty**

10-year limited structural warranty on bamboo with annual maintenance program from the date of purchase. See full details on multi-year warranties for components at

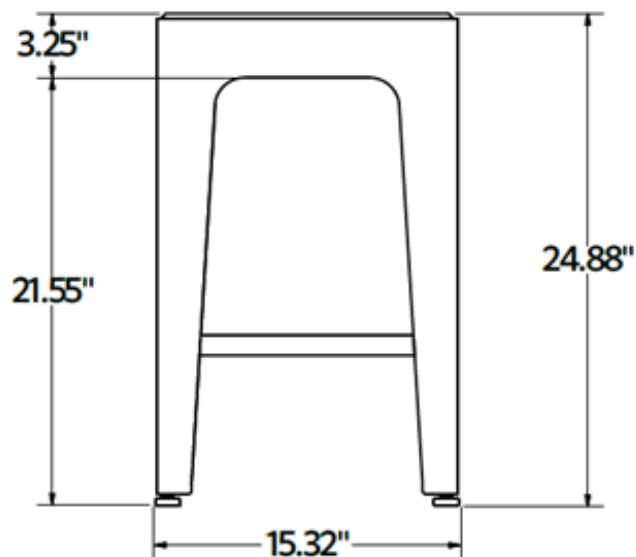
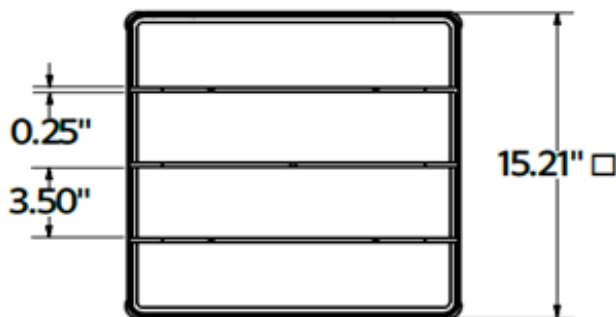
**FRONT VIEW****TOP VIEW****SHIPPING INFORMATION**

Unit Weight	Unit Shipping Wt. UPS	Unit Shipping Wt. Truck (1+ Units)	Unit Ship Size w/Pallet	Max Units Per Pallet	Pallet Size/Wt. (32" X 48")	Total No. Pkgs.	Shipping Class
28 lbs.	N/A	31 lbs./unit	26.67 cu. ft.	4	50 lbs.	1	250