

**CIRBLEBRS2— Circle Stainless Steel Bike Rack, Surface Mount**

**Circle shape stainless steel bike rack, surface mount**

**Material**

The bike rack is 32.25" tall and made from 2.38" O.D. Schedule 10, 316L stainless steel pipe support sections. 316/316L stainless steel derives its advantage through an addition of at least 2% molybdenum. Molybdenum provides increased resistance to corrosion including sea water and deicing salt environments. Bike rack will accommodate up to two bikes, one on each side of the rack.

The bike rack is designed to be surface mounted. Each leg features a 7.75" x 5.5" plate with three .5" diameter predrilled holes for surface mounting to prevent movement.

**Surface mounting is required;** mounting hardware is not included.

**Finish**

316/316L stainless steel is highly resistant to salt corrosion, rusting, pitting, and cracking. It remains clean and rust-free without paint or alternative finish.

**Color**

See website or sales representative for color choices.

**Assembly**

The bike rack ships fully assembled and ready for use. Surface mounting may require some assembly.

**Maintenance**

Clean periodically, as conditions dictate. S

**Warranty**

20-year limited structural warranty from the date of purchase. See full details on multi-

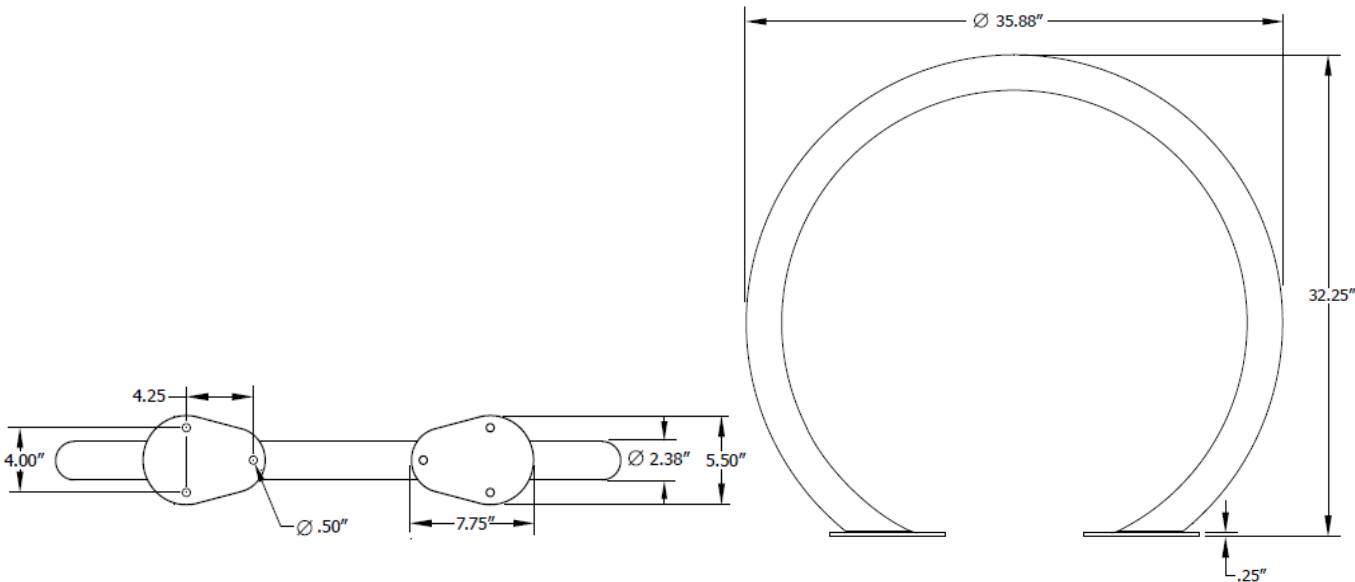

**SHIPPING INFORMATION**

Unit Weight	Unit Shipping Wt. UPS (1-2 Units)	Unit Shipping Wt. Truck (3+ Units)	Unit Ship Size w/Pallet	Max Units Per Pallet	Pallet Size/Wt. (48" X 32")	Total No. Pkgs.	Shipping Class
35 lbs.	38 lbs./unit	38 lbs./unit	10 cu. ft.	8	50 lbs.	1	250