

BH1835R — Beacon Hill Recycled Plastic Receptacle with Open Top

35-gallon receptacle with recycled plastic planks, open top, plastic liner and rubber feet

Material

The receptacle is 31.51" tall and is composed of nominal 1" x 4" recycled plastic planks with choice of horizontal or vertical plank placement and an extruded aluminum frame. Flexible modular design allows for customization; call for information.

The recycled plastic planks are impervious to moisture and corrosion, do not require the application of sealants or preservatives, and will never need painting or staining throughout the product's life.

The top is made from 11-gauge steel with an 11.13" square waste opening and lifts off for easy waste disposal.

The receptacle is designed to be portable for flexibility in placement or surface mounted using .5" predrilled holes in the base to prevent movement. The rubber feet are adjustable to assist in leveling the receptacle. The reusable plastic liner is made of high-density polyethylene. The mounting hardware is not included.

Finish

Fade-resistant, powder coated steel and aluminum components feature a state-of-the-art primer proven to prevent rusting. Treated components exceed the industry standard by 34% in testing by independent sources.

Color

See website or sales representative for color choices.

Assembly

The receptacle ships fully assembled and ready for use.

Maintenance

The product is virtually maintenance-free and requires only periodic cleaning with a sponge and a mild detergent and water solution to remove surface dirt. Do not clean with solvent or petroleum base products.

Warranty

20-year limited structural warranty

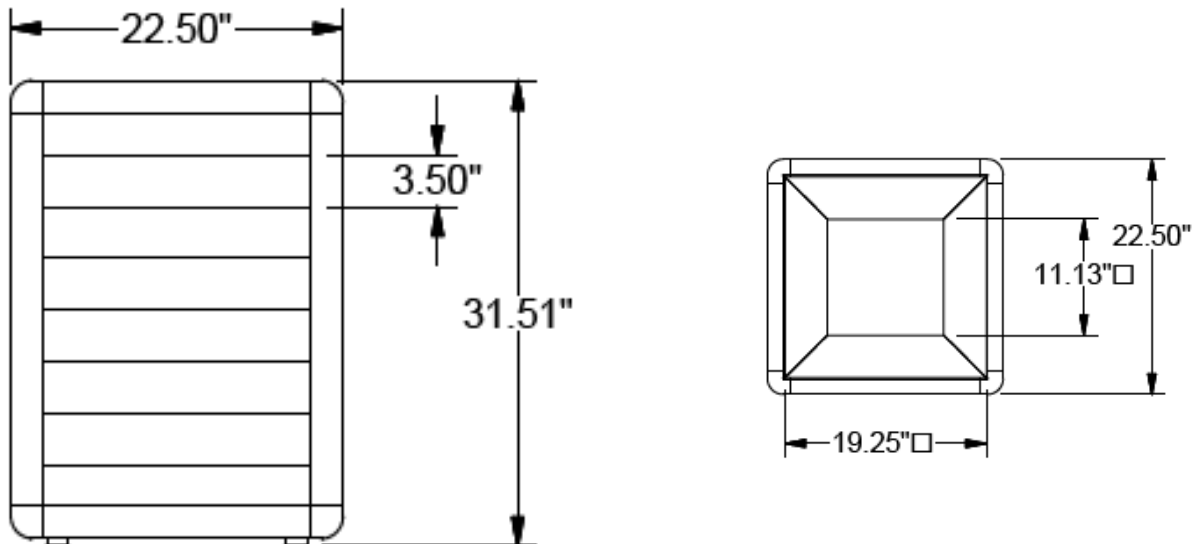
**SHIPPING INFORMATION**

Unit Weight	Unit Shipping Wt. UPS	Unit Shipping Wt. Truck (1+ Units)	Unit Ship Size w/Pallet	Max Units Per Pallet	Pallet Size/Wt. (32" x 48")	Total No. Pkgs.	Shipping Class
118 lbs.	N/A	122 lbs./unit	28 cu. ft.	2	50 lbs.	1	125