

BH1831B – Beacon Hill Bamboo ADA Table with 3 Flat Seats

42" square ADA table with bamboo planks and three flat seats, surface mount

Material

The ADA table has a 41.52" square table top, features three flat seats and meets federal ADA requirements. The table top frame is 10-gauge steel and the table top and flat seats are composed of 1" x 3.5" (1" x 4" nominal dimensions) and 1" x 2" bamboo planks. The table top features a 1.64" diameter umbrella hole in the center and is designed to support 100 lbs. per square foot.

The seats are composed of aluminum and steel plates and are designed to support 200 lbs. per linear foot.

The table frame and legs are made of 2.38" O.D. steel tubing and feature a built-in umbrella holder. The table legs have feet with predrilled .4" diameter holes for surface mounting to prevent movement. Table **must be surface mounted** for stability and to comply with warranty and federal regulations; mounting hardware is not included.

Mature exterior grade bamboo is selected from sustainably harvested sources and engineered into planks using low V.O.C. adhesives. Planks feature a Janka hardness rating of 1450 that is superior to teak. Bamboo has 20% more stability in climate and temperature changes than commonly used timber. Bamboo has a Class A fire rating—ASTM E 84 Surface Burning.

Finish

Fade-resistant, powder coated steel and aluminum components feature a state-of-the-art primer proven to prevent rusting. Treated components exceed the industry standard by 34% in testing by independent sources.

Bamboo planks feature a UV-resistant stain.

Color

See website or sales representative for color choices.

Assembly

The table requires some assembly. The table top and seats ship pre-assembled. Stainless steel assembly hardware is included.

Maintenance

See annual maintenance program.

Warranty

10-year limited structural warranty on bamboo with annual maintenance program from the date of purchase.



Accessories

- 9' Standard Fabric Color Umbrella
9LPU-CSC
- 9' Premium Fabric Color Umbrella
9LPU-CPC
- Umbrella Brace
UBRACE

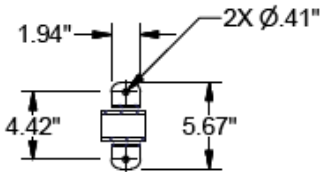

FOOT MOUNT

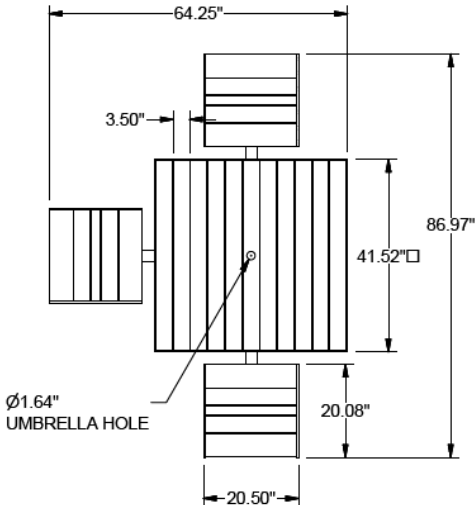
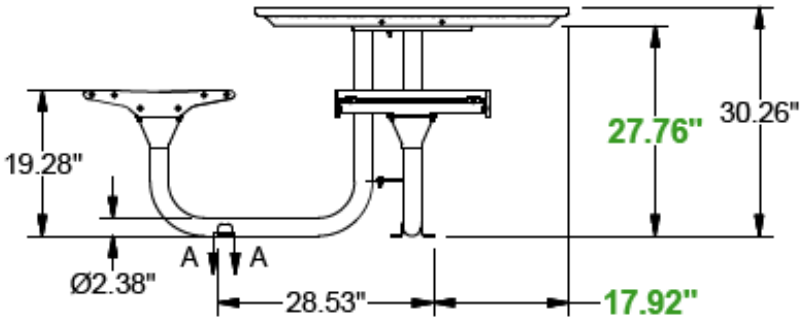

SHIPPING INFORMATION

Unit Weight	Unit Shipping Wt. UPS	Unit Shipping Wt. Truck (1+ Units)	Unit Ship Size w/Pallet	Max Units Per Pallet	Pallet Size/Wt. (48" x 58")	Total No. Pkgs.	Shipping Class
242 lbs.	N/A	278 lbs./unit	50 cu. ft.	1	50 lbs.	5	125