

**BH1801B – Beacon Hill Bamboo Bistro Table with 2 Seats****34" square bistro table with bamboo planks and two seats, surface mount****Material**

The bistro table has a 34" square table top and features two contour seats. The table top frame is 10-gauge steel and the table top and contour seats are composed of 1" x 3.5" (1" x 4" nominal dimensions) bamboo planks. The table top features a 1.64" diameter umbrella hole in the center and is designed to support 100 lbs. per square foot.

The seats are composed of aluminum and steel plates and are designed to support 200 lbs. per linear foot.

The table frame and legs are made of 2.38" O.D. steel tubing and feature a built-in umbrella holder. The table legs have feet with predrilled .5" diameter holes for surface mounting to prevent movement.

**Surface mounting is required;** mounting hardware is not included.

Mature exterior grade bamboo is selected from sustainably harvested sources and engineered into planks using low V.O.C. adhesives. Planks feature a Janka hardness rating of 1450 that is superior to teak. Bamboo has 20% more stability in climate and temperature changes than commonly used timber. Bamboo has a Class A fire rating—ASTM E 84 Surface Burning.

**Finish**

Fade-resistant, powder coated steel and aluminum components feature a state-of-the-art primer proven to prevent rusting. Treated components exceed the industry standard by 34% in testing by independent sources.

Bamboo planks feature a UV-resistant stain.

**Accessories**

9' Standard Fabric Color Umbrella	9LPU-CSC
9' Premium Fabric Color Umbrella	9LPU-CPC
Umbrella Brace	UBRACE

**Color**

See website or sales representative for color choices.

**Assembly**

The table requires some assembly. The table top and seats ship pre-assembled. Stainless steel assembly hardware is included.

**Maintenance**

See annual maintenance program.

**Warranty**

10-year limited structural warranty on bamboo with annual maintenance program

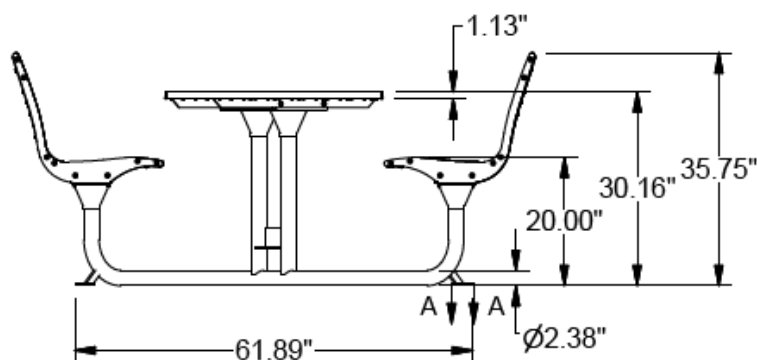
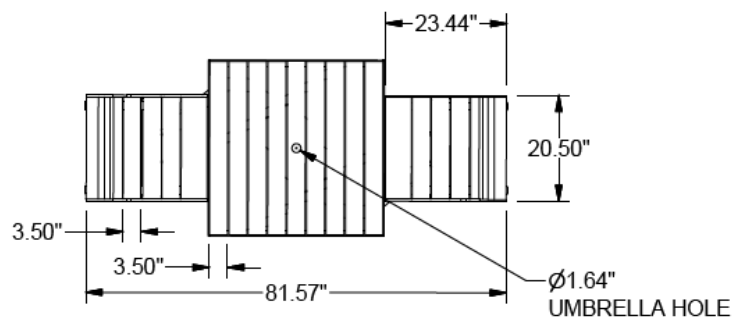
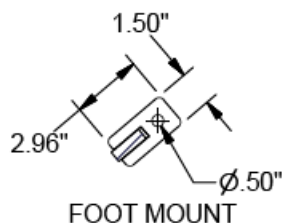
**SHIPPING INFORMATION**

Unit Weight	Unit Shipping Wt. UPS	Unit Shipping Wt. Truck (1+ Units)	Unit Ship Size w/Pallet	Max Units Per Pallet	Pallet Size/Wt. (32" x 74")	Total No. Pkgs.	Shipping Class
195 lbs.	N/A	217 lbs./unit	41 cu. ft.	1	100 lbs.	5	100